

# Assembly Instructions

## Accessory Bracket SAU7

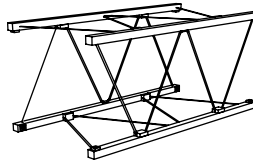

# STOWaway®

PAT.US 6,715,255 B2

## Folding Truss System

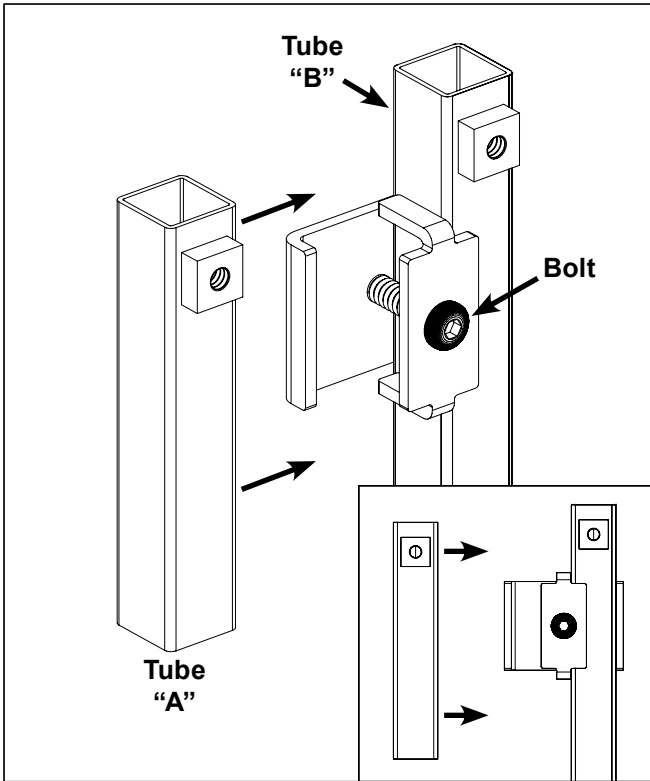

### Step 1

Loosen the **Accessory Bracket's Bolt**, so you can wrap it around **Tube "B"**. Then wrap it around **Tube "A"** in a parallel position.

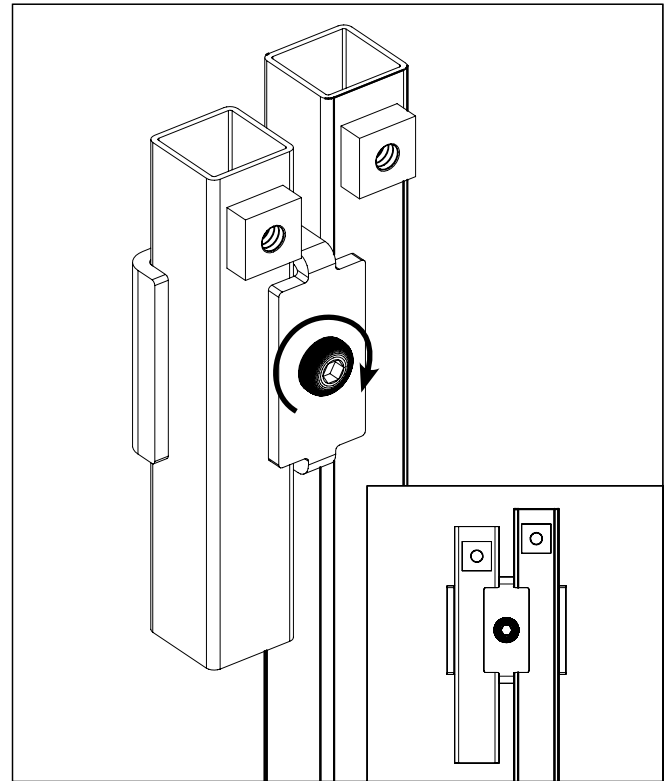

### Step 2

Then tighten the **Accessory Bracket's Bolt** down, so the tubes are secure.

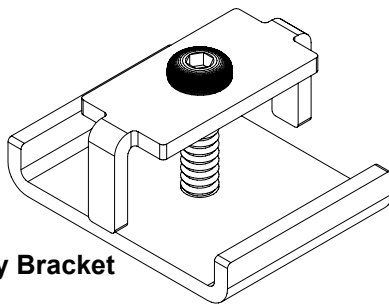

Accessory Bracket

Correct

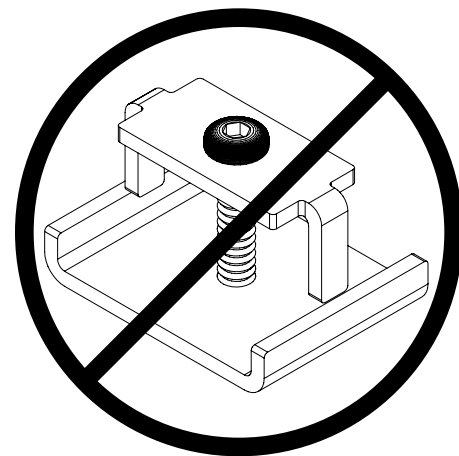

Incorrect

**IMPORTANT:** The orientation of the **Accessory Bracket** halves are important. As seen above.

41082 - 05/02/06

# INTERLOCK®

Interlock Structures International, Inc.



Member

7316 Aspen Lane North  
suite 300  
Minneapolis MN 55428-1109

e mail: [info@interlockstructures.com](mailto:info@interlockstructures.com)  
web: [www.interlock.biz](http://www.interlock.biz)

voice: 763.425.1464  
800.468.1497  
fax: 763.425.8205