

Assembly Instructions

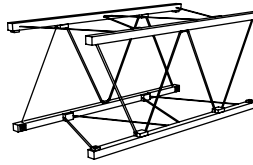

STOWaway®

PAT.US 6,715,255 B2

Folding Truss System

Box Curves

45° SQM1 (Vertical) & SQM2 (Horizontal)

22° SQO1 (Vertical) & SQO2 (Horizontal)

Vertical Box Curve Assembly

45° SQM1

22° SQO1

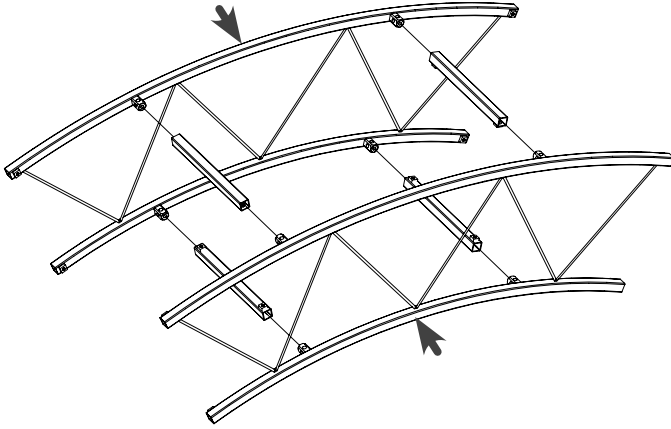

Horizontal Box Curve Assembly

45° SQM2

22° SQO2

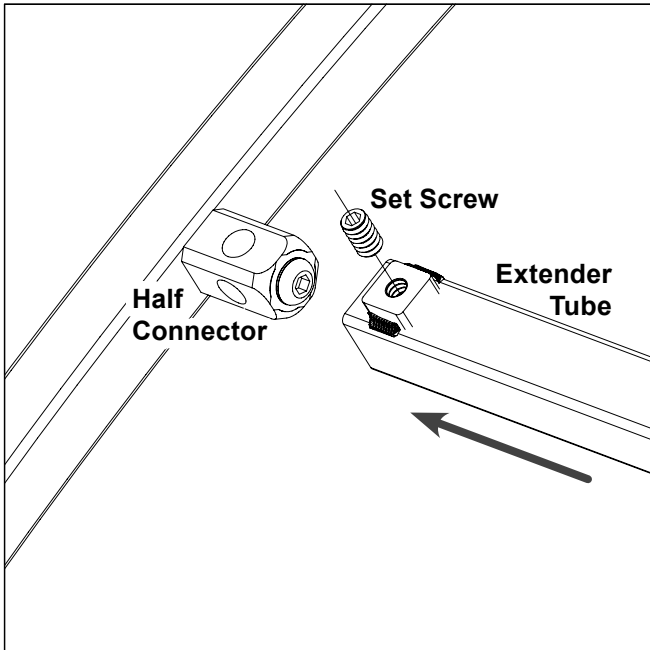
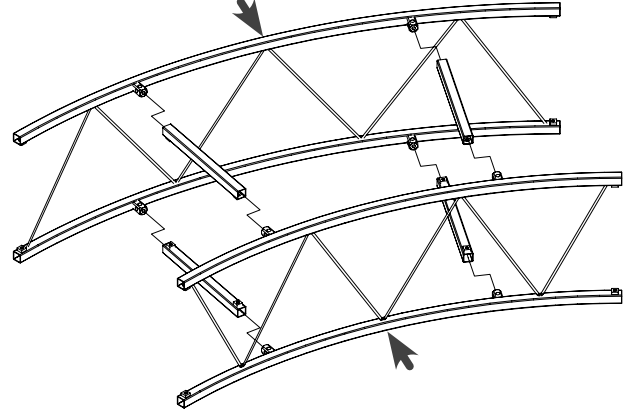

Step 1

Insert the **Set Screw** if missing, and then slide the **Extender Tube** over the **Half Connector**.

Note: For the best look, turn the **Set Screws** to the inside of the truss.

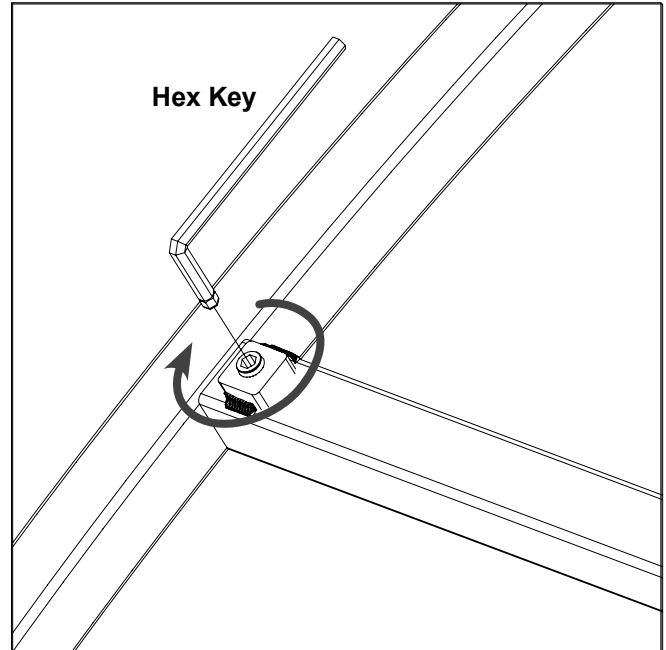

Step 2

Next, tighten the **Set Screw**, with the **Hex Key** provided to secure the connection. Repeat Steps 1 & 2 for the remaining four connections.

41084 - 06/19/06



Member

7316 Aspen Lane North
suite 300
Minneapolis MN 55428-1109

e mail: info@interlockstructures.com
web: www.interlock.biz

voice: 763.425.1464
800.468.1497
fax: 763.425.8205

INTERLOCK®

Interlock Structures International, Inc.